



AVK HANDWHEEL, CTC

08/A-004

Fitting all standard gate valves and service connection valves, #14-32, Ø30-40

For manual operation of AVK gate valves and AVK service connection valves AVK recommends usage of our handwheels. AVK handwheels are of grey cast iron GJL-250 (GG-25) with fusion bonded epoxy coating in compliance with DIN 3476 part 1 and EN 14901.

Product description:

Handwheel assembled with bolt and washer

Features:

- Handwheel for service connection valves with black epoxy
- Handwheel for gate valves with blue epoxy



Expect... **AVK**

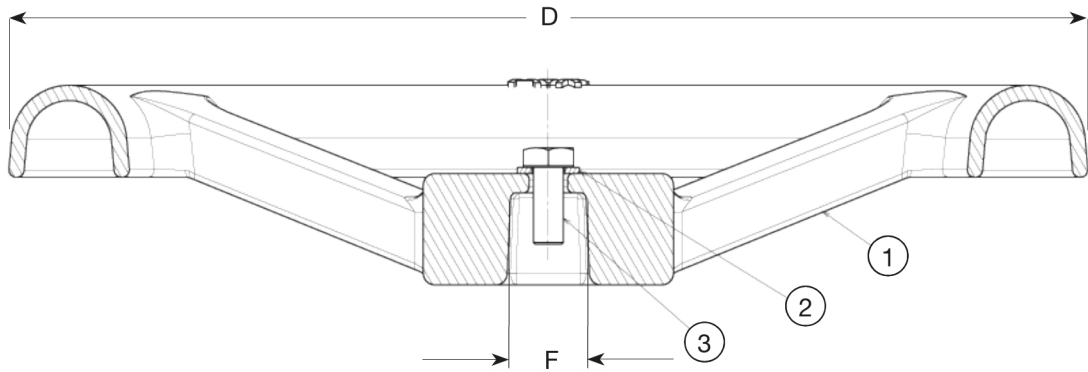

Component list:

1. Handwheel	Cast iron GJL-250 (GG-25)	3. Bolt	Stainless steel A2
2. Washer	Stainless steel A2		

Components may be substituted with equivalent or higher class materials without prior notification.

Reference nos. and dimensions:

AVK ref. no.	DN/DN	D mm	F mm	Theoretical weight/kg
08-032-16 (1)	25 - 50	120	13	0.2
08-050-01-000	40 - 50	180	14	1.5
08-080-02-000	65 - 80	225	17	1.5
08-100-01-000	100 - 100	280	19	2.8
08-150-02-000	125 - 150	320	19	3.6
08-200-01-000	200 - 200	360	24	5.3
08-250-02-000	250 - 300	500	27	8.6
08-400-01-000 (2)	350 - 500	640	32	15
08-600-01-000 (3)	450 - 600	800	Ø30	20
08-600-03-000 (4)	450 - 600	800	Ø40	20

(1) For service connection valves

(2) Square stem

(3) CTC, for series 06 and 46, ø30 keyway

(4) CTC, ø40 keyway